

VWT Jig

Universal Large Wheel Motor Jig

(Part No. TL02093)

The Trilift® Universal Large Wheel Motor Jig is bolted to the Trilift® Variable Work Table XC20/25/30 and used to assist with the removal and installation of large AC wheel motors on most makes and models of ultra-class trucks (with pay loads in excess of 240 tonne).

The Trilift® Universal Large Wheel Motor Jig is fitted with fork tine recesses and is supplied complete with chains and turnbuckles for the retaining of the assembly.

Universal design allows for wide range of application including:

- Komatsu 930, 960 and 980E
- Leibherr 264, 282 and 284
- Hitachi EH4000 and EH5000
- A separate jig is available for CAT models.

Key Operating Data

Working Load Limit	61729	28000 kg
Tare weight	930 kg	930 kg

Features and Benefits

- Fork tyne pockets & lifting lugs for ease of handling
- Adjustable for varying size wheel motors
- Safety chains and spacers supplied



Key Dimensions (approximately)

A	Overall width	71.6in	1820mm
B	Fork tine pocket width	61in	1550mm
C	Max. Adaptor length	91.5in	2325mm
D	Min. Adaptor length	65.7in	1669mm
E	Jig height	20.2in	512mm
F	3.9in packer	3.9in	100mm
G	7.8in packer	7.8in	200mm
H	Packer length	68.8in	1750mm
J	Overall length	99.3in	2524mm

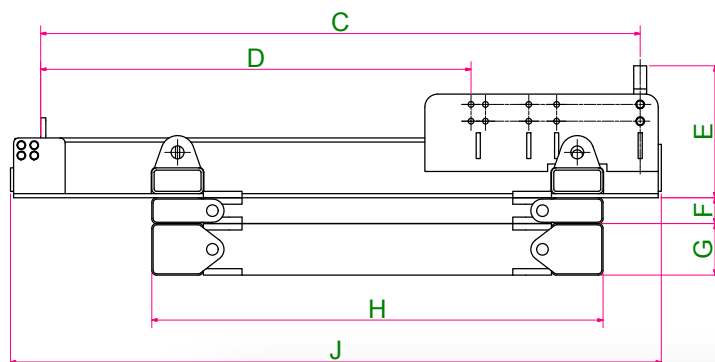
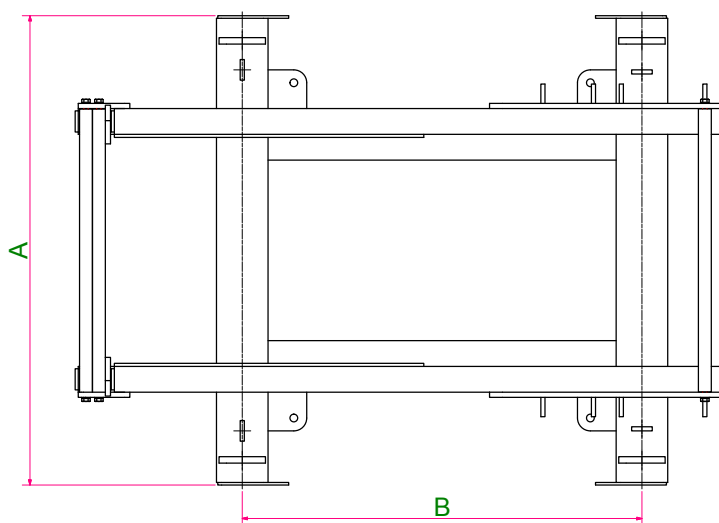

Specifications

The Trilift® Large Wheel Motor Jig is compliant with the following standards:

- AS 3990:1993 - Mechanical Equipment Steelwork
- AS/NZS 1554.1:2004 - Structural Steel Welding
- AS 1418.1-2002 - Cranes, Hoists and Winches
- AS 1163 - Structural Steel Hollow Sections
- AS/NZS 1594 - Hot Rolled Steel Flat Products
- AS/NZS 3679 - Structural Steel
- AS/NZS 3679.1:2011 - Hot Rolled Bars and Sections
- AS/NZS 1252 High strength steel bolts with associated nuts and washers for structural engineering