

VWT Jig

Universal Large Wheel Motor Jig (Part No. TL02093)

The Trilift® Universal Large Wheel Motor Jig is bolted to the Trilift® Variable Work Table XC20/25/30 and used to assist with the removal and installation of large AC wheel motors on most makes and models of ultra-class trucks (with pay loads in excess of 240 tonne).

The Trilift® Universal Large Wheel Motor Jig is fitted with fork tyne recesses so that the jig can be used as a transportation frame. The jig is supplied complete with chains and turnbuckles for the retaining of the assembly.

Key Operating Data

Working Load Limit	61729.4lbs	28,000 kg
Tare weight	2050.3lbs	930 kg

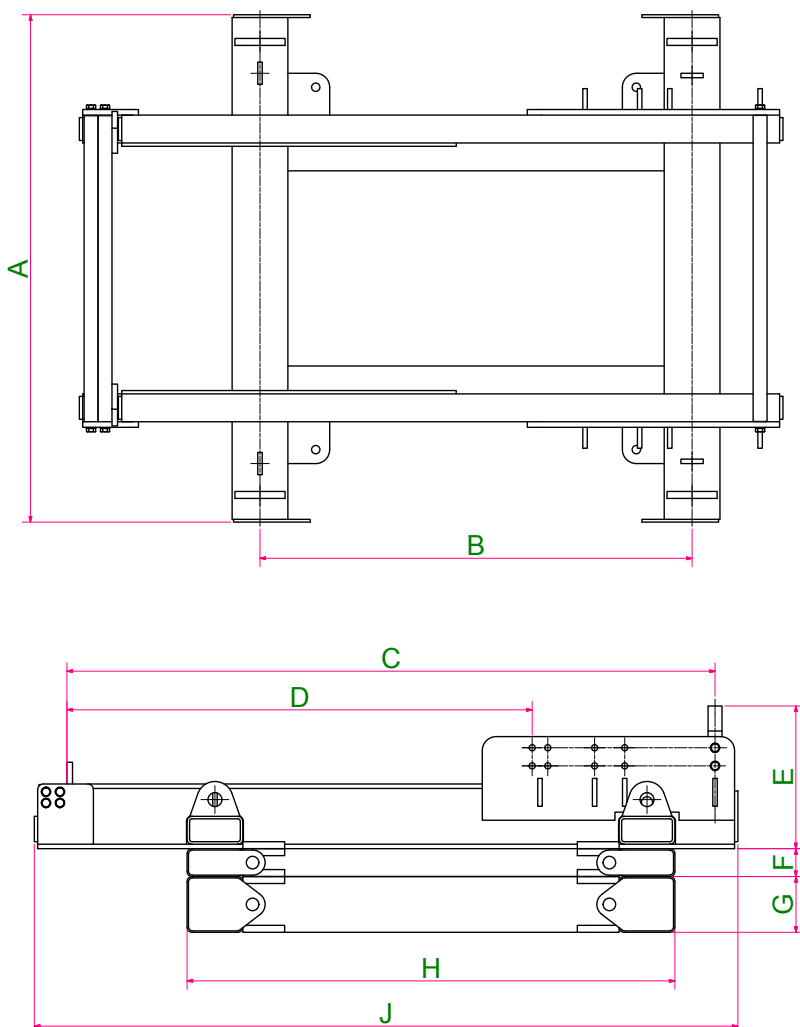

Features and Benefits

- Fork tyne pockets & lifting lugs for ease of handling
- Adjustable for varying size wheel motors
- Safety chains and spacers supplied

Key Dimensions (approximately)

A	Overall width	71.6in	1820mm
B	Fork tyne pocket width	61in	1550mm
C	Max. Adaptor length	91.5in	2325mm
D	Min. Adaptor length	65.7in	1669mm
E	Jig height	20.2in	512mm
F	3.9in packer	3.9in	100mm
G	7.8in packer	7.8in	200mm
H	Packer length	68.8in	1750mm
J	Overall length	99.3in	2524mm

Specifications

The Trilift® Large Wheel Motor Jig is compliant with the following standards:

- AS 3990:1993 - Mechanical Equipment Steelwork
- AS/NZS 1554.1:2004 - Structural Steel Welding
- AS 1418.1-2002 - Cranes, Hoists and Winches
- AS 1163 - Structural Steel Hollow Sections
- AS/NZS 1594 - Hot Rolled Steel Flat Products
- AS/NZS 3679 - Structural Steel
- AS/NZS 3679.1:2011 - Hot Rolled Bars and Sections
- AS/NZS 1252 High strength steel bolts with associated nuts and washers for structural engineering



MHG00182 03032015