

VWT Jig

Universal Electric Wheel Motor Jig (Part No. TL02095)



The Trilift® Universal Electric Wheel Motor Jig is designed to assist with the removal and installation of electric wheel motors on trucks and loaders.

The jig is bolted to the Trilift® Variable Work Table and is currently adaptable to suit GE series AC and DC wheel motors. The jig is supplied complete with chains and turnbuckles for the retaining of the assembly.

Features and Benefits

- Lifting lugs for ease of handling
- Adjustable rollers for differing size wheel motors
- Safety chains and turnbuckles supplied

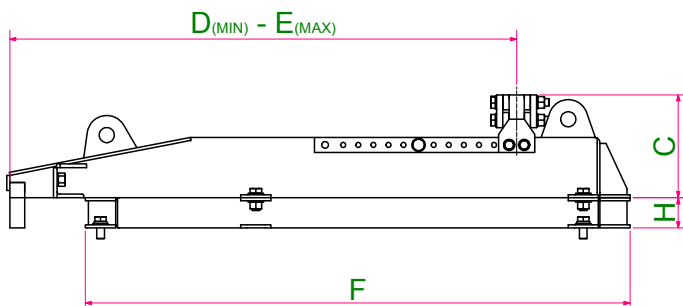
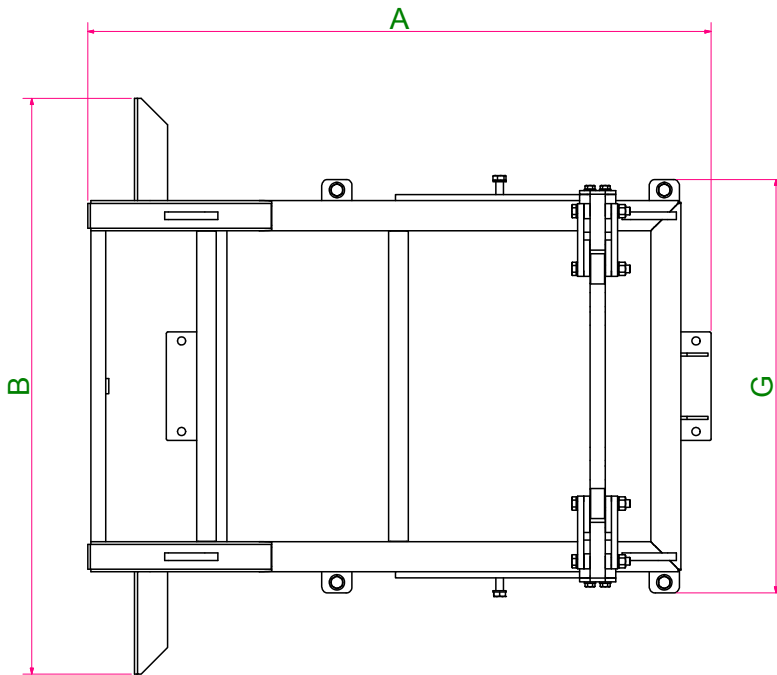

Specifications

The Trilift® Electric Wheel Motor Jig is compliant with the following standards:

- AS 3990 - 1993 - Mechanical Equipment Steelwork
- AS/NZS 1554.1:2004 - Structural Steel Welding
- AS 1418.1-2002 - Cranes, Hoists and Winches
- AS 1163 - Structural Steel Hollow Sections
- AS/NZS 1594 - Hot Rolled Steel Flat Products
- AS/NZS 3679 - Structural Steel
- AS/NZS 3679.1:2011 - Hot Rolled Bars and Sections
- AS/NZS 1252 High strength steel bolts with associated nuts and washers for structural engineering

Key Operating Data

Working Load Limit	33,069lbs	15,000 kg
Tare weight	859 lbs	390 kgs

Key Dimensions (approximately)

A	Length	81in	2066mm
B	Width	75in	1908mm
C	Height	13in	341mm
D	Cradle carrier min	44in	1130mm
E	Cradle carrier max	66in	1680mm
F	Packer(s) length	71in	1805mm
G	Packer(s) width	54in	1370mm
H	Packer height	4in	100mm