

# VWT Jig

## Universal Electric Wheel Motor Jig (Part No. TL02095)



The Trilift® Universal Electric Wheel Motor Jig is designed to assist with the removal and installation of electric wheel motors on trucks and loaders.

The jig is bolted to the Trilift® Variable Work Table and is currently adaptable to suit GE series AC and DC wheel motors. The jig is supplied complete with chains and turnbuckles for the retaining of the assembly.

### Features and Benefits

- Lifting lugs for ease of handling
- Adjustable rollers for differing size wheel motors
- Safety chains and turnbuckles supplied
- 100mm spacer included

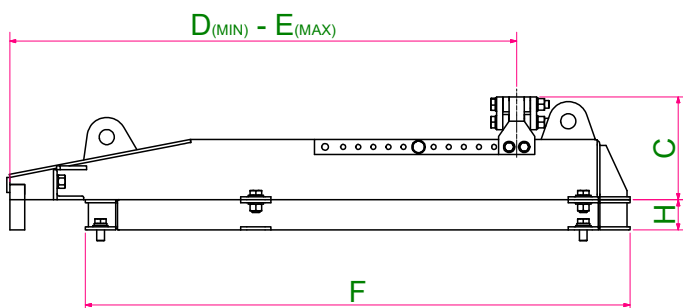
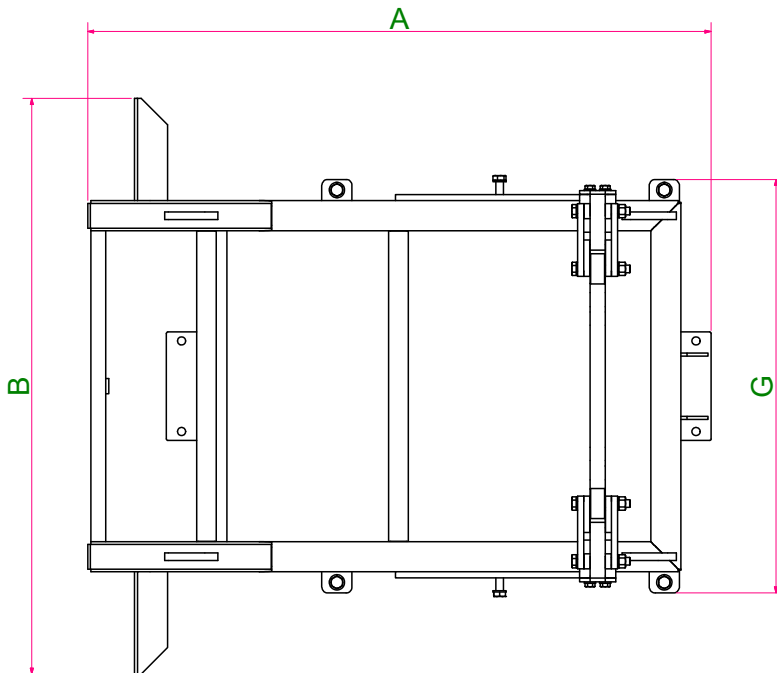

## Specifications

The Trilift® Electric Wheel Motor Jig is compliant with the following standards:

- AS 3990 - 1993 - Mechanical Equipment Steelwork
- AS/NZS 1554.1:2004 - Structural Steel Welding
- AS 1418.1-2002 - Cranes, Hoists and Winches
- AS 1163 - Structural Steel Hollow Sections
- AS/NZS 1594 - Hot Rolled Steel Flat Products
- AS/NZS 3679 - Structural Steel
- AS/NZS 3679.1:2011 - Hot Rolled Bars and Sections
- AS/NZS 1252 High strength steel bolts with associated nuts and washers for structural engineering
- ☐ AS4991 - Lifting devices

### Key Operating Data

Working Load Limit	15,000 kg	33,069lbs
Tare weight	555 kg	859lbs

### Key Dimensions (approximately)

A	Length	2066mm	81in
B	Width	1908mm	75in
C	Height	341mm	13in
D	Cradle carrier min	1130mm	44in
E	Cradle carrier max	1680mm	66in
F	Spacer length	1805mm	71in
G	Spacer width	1370mm	54in
H	Spacer height	100mm	4in

